



WM4549 – Resilient Water Supply Project

Project Description: As part of the overall Columbia Canal Recovery from the October 2015 flood, Columbia Water will be installing a new water supply intake in the Congaree River. This intake will operate independently of the existing Canal water supply system and is designed for an ultimate withdrawal capacity of 80 million gallons per day. The new intake will serve as a redundant water source and piping delivery system to the Canal Water Treatment Plant, securing the water supply to a population of over 200,000 for years to come.

Project Funding: The project is being funded through a combination of Columbia Water capital improvement program funds and a FEMA Building Resilient Infrastructure and Communities grant. The total project cost is \$63.8M, which includes \$2M in owner directed contingency. Grant funding will cover approximately one-half of the project cost at \$32.6M.

Project Status and Schedule: The project was competitively bid in October of this year and the construction contract with the lowest responsive bidder is on the December 3rd City Council agenda for consideration. Construction is anticipated to take approximately 30 months to reach final completion.

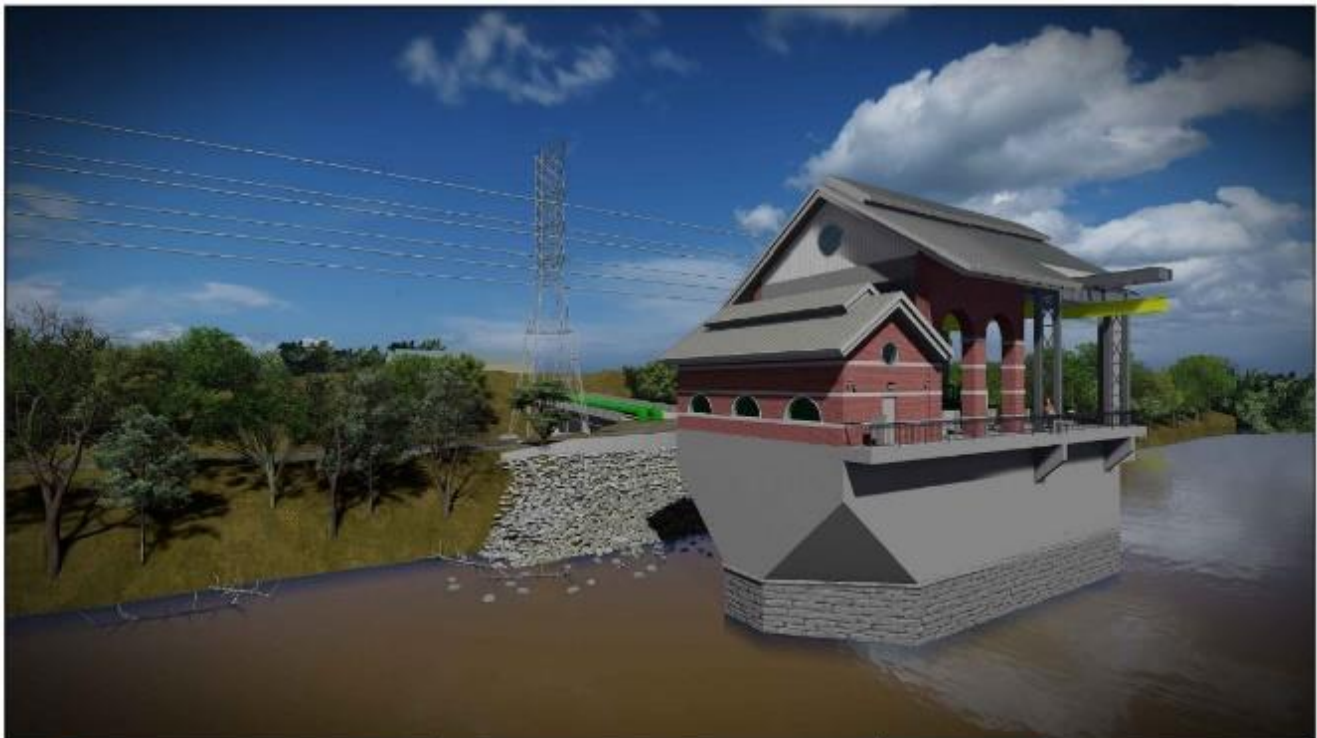

COLUMBIA CANAL RECOVERY
INTAKE RENDERING
October 2024

